

MOJAVE® Three Phase, High Ambient Commercial Condenser Fan, 6.3" Diameter, Open Drip Proof, Air Over



APPLICATIONS:

Designed to meet manufacturer's requirements for condenser cooling fans in commercial air conditioning applications where 3 phase power is required.

FEATURES:

- Open Drip Proof, Shaft-Up Design
- 70°C (158°F) Max Ambient
- Continuous Duty, Air Over
- Ball Bearings Have All Angle Thrust System
- Voltage Change Device
- Class F Insulation
- Reversible Rotation
- Automatic Thermal Protector
- Keyway and Flat Shaft
- 208v will not be marked on DOE regulated spread-voltage motors. Refer to online data

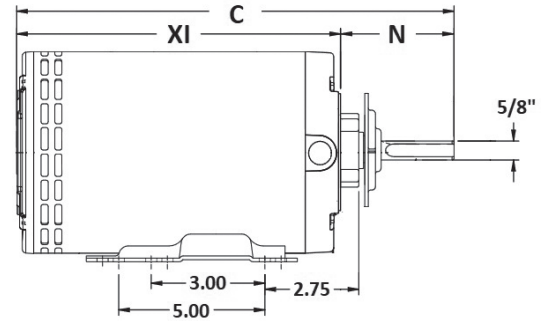

Belly Band Mount

HP	RPM	Voltage	Catalog Number	List	Frame	Amps	Shaft N	Shell XI	Total C	Ship Wt. (lbs)
3/4	1140	208-230/460	1817H	\$526	56Z	2.8/1.4	6.0	9.3	15.3	31.5
1	1140	208-230/460	1818H	\$555	56Z	4.2/2.1	6.0	8.8	14.8	27.34
	850	208-230/460	1828H	\$732	56Z	4.8/2.4	6.0	10.8	16.8	40.02
	850	575	1829H	\$940	56Z	2.1	6.0	10.8	16.8	40.46
1 1/2	1140	208-230/460	1819H	\$612	56Z	5.4/2.7	6.0	9.8	15.8	35
	850	208-230/460	1832H	\$804	56Z	6.8-6.6/3.3	6.0	10.8	16.8	44.1
2	1140	208-230/460	8987H	\$665	56Z	7.6-7.4/3.7	6.0	10.8	16.8	45

Rigid Base Mount

HP	RPM	Voltage	Catalog Number	List	Frame	Amps	Shaft N	Shell XI	Total C	Ship Wt. (lbs)
3/4	1140	208-230/460	1826H	\$549	56Z	2.8/1.4	6.0	9.3	15.3	31.5
1	1140	208-230/460	1820H	\$555	56Z	4.2/2.1	6.0	8.8	14.8	27
	850	208-230/460	1833H	\$754	56Z	4.8/2.4	6.0	10.8	16.8	31.5
	850	575	1834H	\$754	56H	1.7	6.0	10.8	16.8	31.5
1 1/2	1140	208-230/460	1821H	\$619	56Z	5.4/2.7	6.0	9.8	15.8	35
	850	208-230/460	1831H	\$783	56	6.8-6.6/3.3	6.0	10.8	16.8	45
2	1140	208-230/460	1822H	\$675	56Z	7.6-7.4/3.7	6.0	10.8	16.8	45

